

The Imperium Eskaton

@BMA Road, Eskaton



“The Imperium Eskaton”

Overall Facilities with Aesthetic Design:

- 24/7 monitoring through CCTV surveillance system
- One electrical substation
- Uninterrupted power supply through standby generators
- Two passenger lifts
- Car parking facility (entire ground floor)
- Standard Apartment: 3 bedrooms, 1 drawing room, 1 dining room, 5 balconies, 3 bathrooms, and 1 kitchen
- Fitness center
- Intercom facility
- Green zone
- Swimming pool
- Kids' zone
- Firefighting system
- Mosque
- Community center
- Open spaces to ensure adequate light and ventilation
- 24/7 security system with trained security guards
- Seating arrangements in the green zone

The Apartment Distribution Will Be Conducted Through A Lottery System.



TYPICAL FLOOR PLAN

LAND AREA
15000 SFT

20.84
katha

10 STORIED
RESIDENTIAL
BUILDING

NUMBER OF FLOORS
G + 9

72 NUMBER OF
TOTAL UNIT

PER FLOOR
8 units

PER UNIT SIZE:
1656 SFT

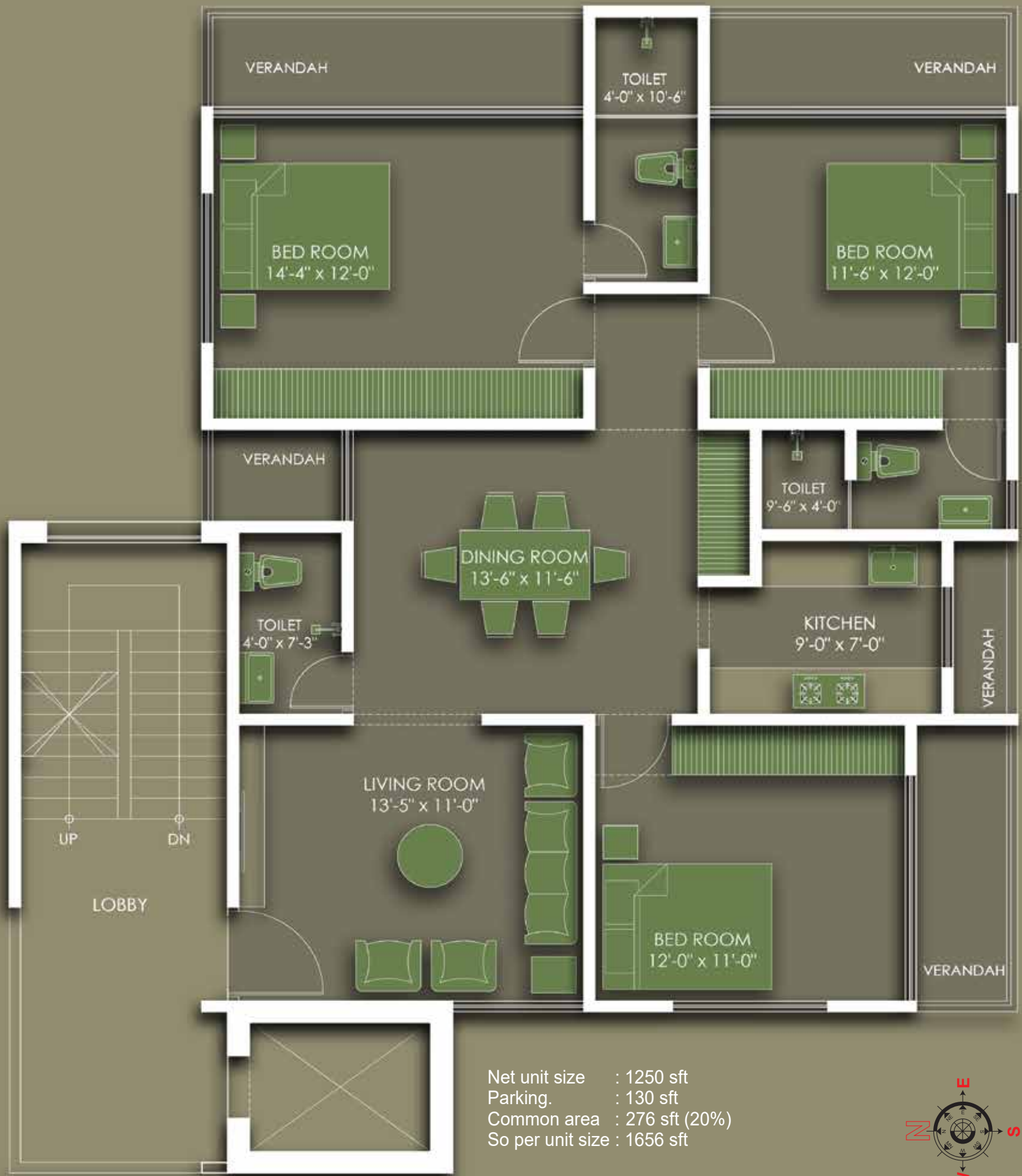

Net unit size : 1250 sft
 Parking : 130 sft
 Common area : 276 sft (20%)
 So per unit size : 1656 sft

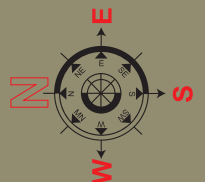

TYPICAL FLOOR PLAN

**1 MASTER BEDROOM | 1 GUEST BEDROOM | 1 COMMON BEDROOM
 1 ATTACHED BATHROOM | 1 COMMON BATHROOM | 5 VERANDA**



— A Project of



PUSHPO HOMES LTD.

Head Office:

- L K Tower-2 (Level-11), 59 & 61 Gulshan South Avenue, Gulshan-1, Dhaka-1212
- pushpohomes@gmail.com

Sales Office:

- Gemcon Business Center, Level-7 & 8 255, New Circular Road Malibagh Mor, Dhaka-1217.
- Hosaf Tower 6/9, Level 2, 3 & 4, Outer Circular Road, Malibagh Mor, Dhaka-1217

Overall Facilities

- 24/7 monitoring through CCTV surveillance system.
- One electrical substation
- Uninterrupted power supply through standby generators
- Two passenger lifts
- Car parking facility (entire ground floor)
- Fitness center
- Intercom facility
- Green zone
- Kids' zone
- Fire Fighting system
- Mosque
- Community center
- 24/7 security system



WELCOME AND
BE A FLAT OWNER

SAVE **40%** COST



AREA DETAILS

NET UNIT SIZE: 1250 SFT

PARKING SIZE: 130 SFT

**COMMON AREA: 276 SFT
(20%)**

PER UNIT SIZE: 1656 SFT

TYPICAL FLOOR PLAN

LAND AREA 15000 SFT	20.84 katha	10 STORED RESIDENTIAL BUILDING	6 + 9 FLOOR IN FLOOR	72 NUMBER OF TOTAL UNIT	8 UNITS	PER UNIT SIZE 1656 SFT
-------------------------------	-----------------------	--	--------------------------------	--------------------------------------	-------------------	----------------------------------



TYPICAL FLOOR PLAN
1 MASTER BEDROOM | 1 GUEST BEDROOM | 1 COMMON BEDROOM
1 ATTACHED BATHROOM | 1 COMMON BATHROOM | 5 VERANDA



FLAT CONFIGURATION

NO OF MASTER BEDROOM: 01

NO OF CHILD BEDROOM: 01

NO OF GUEST BEDROOM: 01

NO OF ATTACHED BATHROOM: 02

NO OF COMMON BATHROOM: 01

NO OF KITCHEN: 01

NO OF VERANDA: 05

LAND AREA		20.84		10		STORED RESIDENTIAL BUILDING		G + 9		72		NUMBER OF TOTAL UNIT		8		PER UNIT SIZE	
15000 sft		katha												units		1656 sft	



Net unit size : 1250 sqft
Parking : 130 sqft
Common area : 276 sqft (20%)
So per unit size : 1656 sqft

TYPICAL FLOOR PLAN
1 MASTER BEDROOM | 1 GUEST BEDROOM | 1 COMMON BEDROOM
1 ATTACHED BATHROOM | 1 COMMON BATHROOM | 5 VERANDA

ROOM SIZE

M. Bed Room: 14'-4" x 12'-0" SFT

C. Bed Room: 11'-6" x 12'-0" SFT

G. Bed Room: 12'-0" x 11'-0" SFT

Dining Room: 13'-6" x 11'-6" SFT

Living Room: 13'-5" x 11'-0" SFT

Kitchen: 9'-0" x 7'-0" SFT

M B Toilet: 4'-0" x 10'-8" SFT

C B Toilet: 7'-6" x 4'-0" SFT

G B Toilet: 4'-0" x 7'-3" SFT

TYPICAL FLOOR PLAN

LAND AREA 15000 SFT	20.84 katha	10 STORED RESIDENTIAL BUILDING	G + 9 NUMBER OF FLOORS	72 NUMBER OF TOTAL UNIT	8 units	PER UNIT SIZE 1656 SFT
-------------------------------	-----------------------	--	----------------------------------	--------------------------------------	-------------------	----------------------------------



TYPICAL FLOOR PLAN
 1 MASTER BEDROOM | 1 GUEST BEDROOM | 1 COMMON BEDROOM
 1 ATTACHED BATHROOM | 1 COMMON BATHROOM | 5 VERANDA



www.pushpohomes.com

THE IMPERIUM ESKATON

@BMA Road, Eskaton



A Project of



PUSHPO HOMES LTD.

Head Office:
● L.K. Tower-2 (Level 11), 50 & 61 Gulshan
South Avenue, Dhaka-1212
● pushpohomes@gmail.com

Sales Office:
● Sermon Business Center, Level-7 & 8
258, New Circular Road Malibagh Mor,
Dhaka-1217.
● Head Office Tower 6/9, Level 2, 3 & 4, Outer
Circular Road, Malibagh Mor, Dhaka-1217.

TYPICAL FLOOR PLAN

LAND AREA: 15000 SFT | 20.84 Katha | 10 STORED RESIDENTIAL BUILDING | NUMBER OF FLOOR: G + 9 | 72 NUMBER OF TOTAL UNIT | 8 units | PER UNIT SIZE: 1656 SFT



TYPICAL FLOOR PLAN
1 MASTER BEDROOM | 1 GUEST BEDROOM | 1 COMMON BEDROOM
1 ATTACHED BATHROOM | 1 COMMON BATHROOM | 5 VERANDA



" ইন্সটাটনে আমরাই প্রথম"

**"80% কম খরচে ফ্ল্যাটের
মালিক হওয়ার সুযোগ"**

TYPICAL FLOOR PLAN

LAND AREA: 20.84 KATHA

NO OF FLOOR: 10(G+9)

CATEGORY: RESIDENTIAL

NO OF UNIT: 72

PER UNIT SIZE: 1656 SFT



